

TILLAMOOK COUNTY SURVEYORS OFFICE
COURT HOUSE, TILLAMOOK, OREGON 97141

1/4 CORNER COMMON SECTIONS 28 & 29 T.2S., R.9W., W.M.

T2SR9W	
1/4	I found a 2" iron pipe not plugged in a cast iron monument case. (See T.C.S. Rewitness Card #414).
S29+S28	I set a 5/8"X 12" iron rod with a 3" Tillamook County Surveyor Brass Cap in an 8" cast iron monument case and concrete from references after road was reconstructed.
RS 793	
1990	

History of found monument

I found this monument to be as described on T.C.S. Rewitness Card #414 and the references found and/or set at that time to now be as follows:

- "56" nail SE 0.96'; (Now gone).
- "56" nail SW 0.95'; (Now gone).
- "56" nail NW 1.01'; (Now gone).
- "56" nail NE 1.09'; (Now gone).

New Accessories

5/8" iron rod with a Red Tillamook County Surveyors Plastic Cap inscribed "TILLAMOOK CO. SURVEY" N.45*W. 64.97'.

5/8" iron rod with a Red Tillamook County Surveyors Plastic Cap inscribed "TILLAMOOK CO. SURVEY" S.45*E. 72.13'.

5/8" iron rod with a Red Tillamook County Surveyors Plastic Cap inscribed "TILLAMOOK CO. SURVEY" N.53*50'48"E. 67.97'.

5/8" iron rod with a Red Tillamook County Surveyors Plastic Cap inscribed "TILLAMOOK CO. SURVEY" S.42*07'48"W. 71.41'.

Basis of Meridian is a magnetic compass. Angles were turned with a Wild T-16. Distances were measured with a Wild "DI 5" E.D.M.

*84" light hat section post West 45.9'.

*indicates Tillamook County Surveyors yellow metal location poster attached.

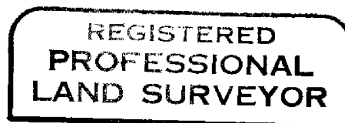

Allan E. Duncan, C.S.

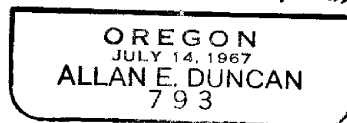

Surveys and Rewitnesses of record not listed on card #414

A-2165	Sept.-71	John L. Carlich	RS 287
B-750	Fall -76	John L. Carlich	RS 287
A-710	Mar. -57	John L. Carlich	RS 287
B-404	Mar. -59	Richard A. Morris	RS 401
B-706	04-12-72	Lester E. Fultz	PE 4571
A-5451	Oct. -86	Allan E. Duncan	LS 793
A-5204	Dec. -84	Allan E. Duncan	LS 793
B-821	Jan. -79	C. Wayne Cook	LS 1098
B-973	Spr. -81	C. Wayne Cook	LS 1098
A-5405	Dec. -84	C. Wayne Cook	LS 1098
A-5127	Aug. -84	C. Wayne Cook	LS 1098
A-5843	09-08-89	C. Wayne Cook	LS 1098
B-1512	04-08-91	Charles D. Curtis	LS 2274
F-27-31	Nov. -83	O.S.H.D.	
F-27-30	1972	O.S.H.D.	
F-20-5	1972	O.S.H.D.	
Rewitness card #414	07-13-78	John L. Carlich	RS 287
Survey Book "S3" Page 128	06-02-98	A.M. Austin	
Survey Book "S3" Page 158	04-20-98	A.M. Austin	
Survey Book "S3" Page 438	10-31-03	A.M. Austin	
Survey Book "S3" Page 508	09-15-17	A.M. Austin	
Field note book "AMA 2" page 13	04-20-98	A.M. Austin	
Field note book "AMA 5" page 49	10-31-03	A.M. Austin	
Field note book "AMA 14" page 53	06-06-97	A.M. Austin	
Rewitness Book 4 page 9	10-31-03	A.M. Austin	
Rewitness Book 10 page 67	12-03-88	R.R. Hayes	
Rewitness Book 1 page 26			

Location of Monument

This corner is located approximately 3' West of the apparent center line in the south bound lane of Highway 101.

In the presence of Al Dvorak and Dan McNutt

December 18, 1990

Title

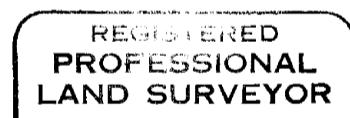

Allan E. Duncan, C.S.

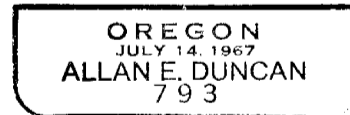

Page 2 of 2